

VEX BEAM 282

A Contemporary LED Flood Light With A Choice of
Colour Options & Beam Angles

282mm Diameter | Indoor & Outdoor Use

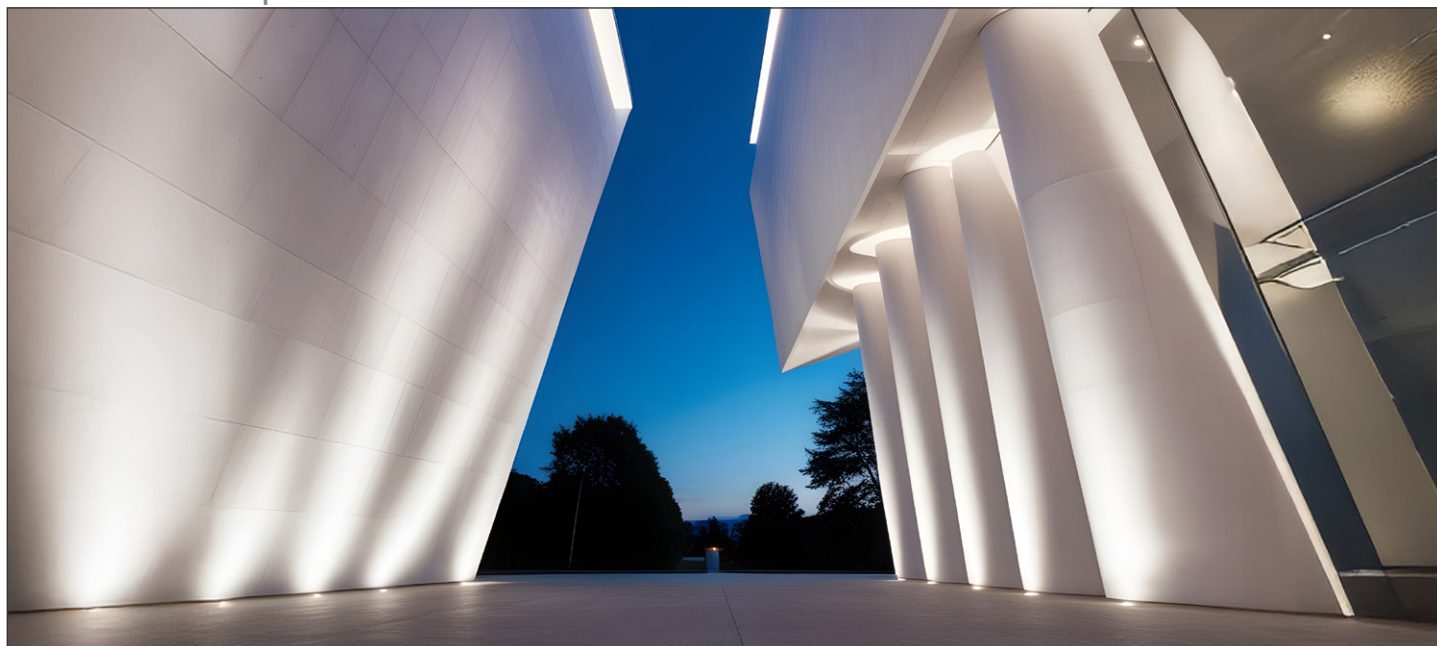

Integrated Driver



Features & Benefits

Robust Construction

A high-quality, powder-coated, die-cast aluminium body and a tempered glass outer lens ensures this luminaire will last.

Pick Your Colour

Available in a choice of static white CCTs, tunable RGBW, or choose the 7 in 1 option (RGBWCLA) for superior colour reproduction with intelligent output balancing.

Beam Angle Selections

Choose from multiple beam angles from an ultra narrow 2.5°, to a wide 60°.

Anti-Glare Accessories

Reduce glare from this luminaire with integrated snoot or honeycomb louvre accessories.

Choose Your Control

Control options for the integrated driver include: On/off, 0-10V PWM, Dali and DMX.

Compliance

UKCA, CE, IP66

5-Year Warranty

Standard 5-year warranty, L70 (Static White) @ >50,000 hours.

LIGHT OUTPUT INFORMATION

Efficacy (lm/W)

		Static White			RGBW ¹				
Fixture Type	Power Output	2700K	3000K	4000K	Max	Red	Green	Blue	White (3000K)
Beam 282	150W	70	75	80	-	-	-	-	-
	200W	-	-	-	45	25	75	10	75

		RGBWCLA (7 in 1) with Output Balancing ²						
Fixture Type	Power Output	Red	Green	Blue	White (3000K)	Cyan	Lime	Amber
Beam 282	200W	20	35	5	40	20	50	25

Luminaire Lumen Output (lm)

		Static White			RGBW ¹				
Fixture Type	Power Output	2700K	3000K	4000K	Max	Red	Green	Blue	White (3000K)
Beam 282	150W	10500	11250	1200	-	-	-	-	-
	200W	-	-	-	9000	1250	3750	500	3750

		RGBWCLA (7 in 1) with Output Balancing ²						
Fixture Type	Power Output	Red	Green	Blue	White (3000K)	Cyan	Lime	Amber
Beam 282	200W	1145	2000	285	2285	1145	2860	1430

The white values above are specified at CRI = 80

If the data that you require is missing, please contact your Vexica representative

¹ RGBW consists of 4 channels (Red, Green, Blue & White), each capable of outputting 1/4 of the total luminaire power output. The 'Max' value is taken when all four channels are at 100% and the fixture is running at its maximum power output.

² 7 in 1' with Output Balancing utilises 7 channels (RGBWCLA) of control for superior colour reproduction. Embedded intelligent control maximises the output at any selected colour. The values above represent the maximum possible lumen output per channel. These are not simultaneously achievable due to output balancing technology.

Vexica run regular development cycles, continuously optimising and balancing product specifications to best suit our customers. All information therefore, is intended as a guide and specifications may change on occasion without notice or announcement. Technical data is measured under controlled conditions, expected performance is within +/- 10% of advertised figures. Luminaire output stated is actual value from the luminaire itself. Information provided above is intended as a description of the product and shall not be used in the form of any contract.

LIGHT OUTPUT INFORMATION CONT.

LED Quantity	36	
CRI	80 (White Only)	
LED Binning	3 SDCM (White Only)	
Dimmable	Yes	
Beam Angle	Static White	2.5°, 8°, 12°, 20°, 30°, 45°, 60°, 10°x60°
	RGBW	9°, 15°, 20°, 30°, 45°, 15°x60°
	RGBWCLA	10°, 15°, 20°, 30°, 15°x60°

ELECTRICAL INFORMATION

Power Options	Static White	150 W
	RGBW & RGBWCLA	200W
Input Voltage	100 - 305 VAC	
Cable Entry	Rear Feed Entry	
Connection Type	Static White	1m 3-Core Power Cable
	RGBW & RGBWCLA	1m 3-Core Power Cable
		1m 4-Core Signal Cable
Control Method	On/Off (Standard for Static White)	
	0 - 10V	
	DMX (Standard for RGBW & exclusively for RGBWCLA)	
	DALI	

PHYSICAL & ENVIRONMENTAL INFORMATION

Housing Colour	<div></div> Grey (RAL9023)
Finish	Powder Coated Die-Cast Aluminium, Tempered Glass
Ambient Operating Temperature	-20°C to +55°C
Ambient Storage Temperature	-55°C to +70°C
IP Rating	IP66
IK Rating	IK08

LED CCT/COLOUR OPTIONS

STATIC WHITE
2700K, 3000K, 4000K



TUNABLE COLOUR
RGBW



7 IN 1 (WITH OUTPUT BALANCING)
RGBWCLA



7 in 1 control with intelligent output balancing technology allows for superior colour reproduction at any level of dimming. This also ensures the maximum output of the luminaire is available independent of the hue selected.

PRODUCT DIMENSIONS

Barrel Diameter (mm)	282
Height (mm)	320
Depth (mm)	135
Weight (kg)	6.0

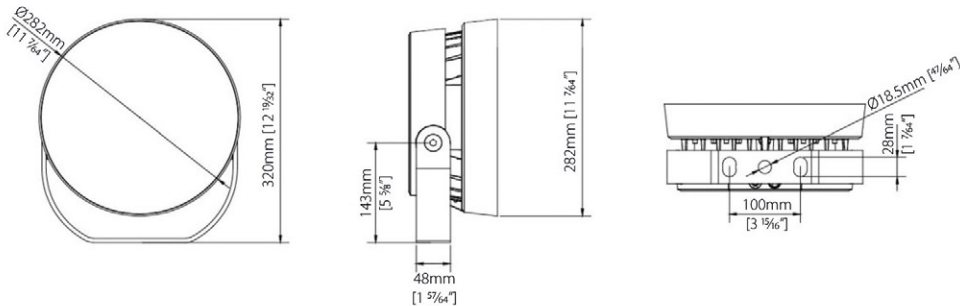

ACCESSORIES

ANTI-GLARE SNOOT

Integrated anti-glare shield for luminaire

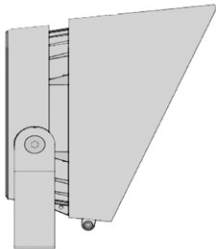

ORDER CODE: 025064

HONEYCOMB LOUVRE

Integrated glare reduction honeycomb

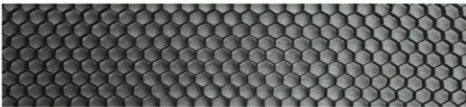

ORDER CODE: 025065

FIXTURE ORDERING

Project Name

1) FIXTURE & OUTPUT TYPE

PRODUCT	CCT/LED COLOUR	
VEX-BEAM-282		
Vex-Beam 282 is a contemporary exterior LED Flood Light Die-Cast Aluminium Body with Toughened Glass Lens 282mm Diameter,	2700K 3000K 4000K RGBW-3000K RGBWCLA-OB	Static White (2700K) Static White (3000K) Static White (3500K) RGBW (3000K) 7 in 1 with Output Balancing (RGBWCLA)

2) POWER & IP RATING

POWER OPTION	IP RATING		
	IP66		
150W 200W	150W (Static White Only) 200W (RGBW & RGBWCLA)	IP66	Water & Dust Proof Suitable for outdoor use

3) BEAM ANGLE & CONTROL TYPE

BEAM ANGLE						CONTROL TYPE	
STATIC WHITE		RGBW		RGBWCLA		OO	On/Off (Standard for Static White)
2.5	2.5°	9	9°	10	10°	0-10V	0-10V PWM Dimming
8	8°	15	15°	15	15°	DALI	DALI Controlled Dimming
12	12°	20	20°	20	20°	DMX-512	DMX Controlled Dimming
20	20°	30	30°	30	30°		(Standard for RGBW & Only Option for RGBWCLA)
30	30°	45	45°	15x60	15°x60°		
45	45°	15x60	15°x60°				
60	60°						
10x60	10°x60°						

PRODUCT CODE:

EXAMPLE: VEX - BEAM - 282 - 2700K - 150W - IP66 - 60 - DMX - 512

ACCESSORIES

PART NO.	DESCRIPTION	PRODUCT CODE
025064	Integrated Snoot/Hood	VEX-BEAM-282-ACCESSORY-SNOOT
025065	Anti-Glare Honeycomb Louvre	VEX-BEAM-282-ACCESSORY-HONEYCOMB-LOUVRE

STANDARDS & CERTIFICATIONS

Compliance

Standard Marks



Environmental Suitability

Recyclable

Aluminium body recyclable where facilities exist.

Reliability

Quality Assurance

All products are carefully selected and tested by Vexica so that you can be assured of their quality, function and reliability.

Warranty & Terms

Terms & Conditions

Warranty Registration

For details on our warranty and business terms, please click or scan the QR Code.

Notes