

# NEON-LINE S - SWIM

**VEXICA**

A Side-Bending Flexible Luminaire For Use In and Around Swimming Pools.

11.5mm x 20mm | Side Bending | IP68 Suitable for Pools

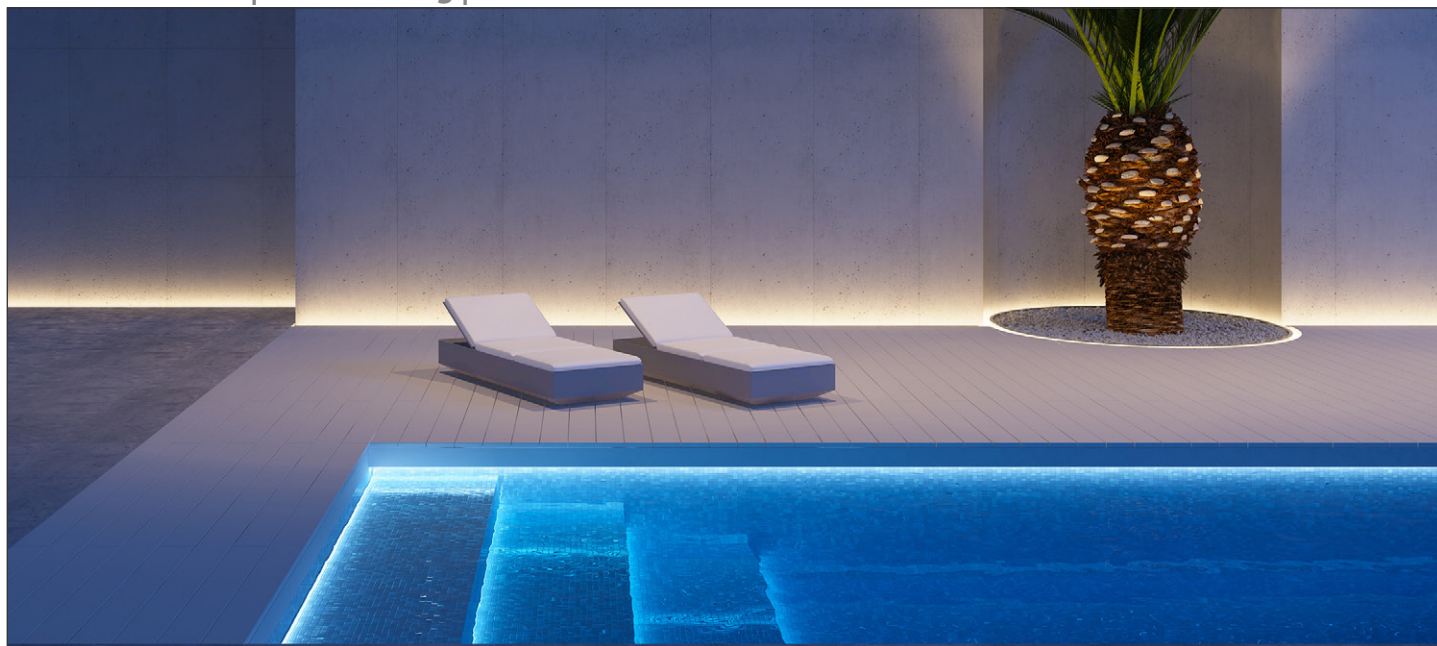

**MADE IN  
BRITAIN**®

## Features & Benefits

### Perfect for Underwater Pool Use

Compliant with IEC 60598-2-18, this luminaire is IP68 rated, with excellent chlorine stability and is submersible up to 3m.

### Side Bending

Flexible in the side direction this luminaire can effortlessly conform to the most complex profiles.

### Select From a Range of CCTs and Colours

Choose from a variety of static white CCTs, Tunable White or RGB. White at CRI 90 as standard.

### Superior Flexible Technology

Fully encapsulated in high-grade silicone for maximum flexibility, longevity and environmental robustness.

### Diffuse Dot-Free Output

Diffused opal finish for homogeneous appearance.

### Choose Your Length

Available in factory prepared lengths in 50mm increments up to 5004mm. MoQs per length apply.

### Compliance

UKCA, CE, IP68

### 3-Year Warranty

Standard 3-year warranty, L70 @ >50,000 hours.

LIGHT OUTPUT INFORMATION

Efficacy (lm/W)

		Static White						
Fixture Type	Power Output	2700K	3000K	3500K	4000K	5000K	6000K	
Neon-Line S - Swim	14 W/m	30	31	33	34	33	33	
		Tunable White <sup>1</sup>				RGB <sup>2</sup>		
Fixture Type	Power Output	2500K	4500K	Mid-Range	Max (White)	Red	Green	Blue
Neon-Line S - Swim	14 W/m	TBC	TBC	TBC	17	11	33	7

Luminaire Lumen Output (lm/m)

		Static White						
Fixture Type	Power Output	2700K	3000K	3500K	4000K	5000K	6000K	
Neon-Line S - Swim	14 W/m	420	435	460	475	460	460	
		Tunable White <sup>1</sup>				RGB <sup>2</sup>		
Fixture Type	Power Output	2500K	4500K	Mid-Range	Max (White)	Red	Green	Blue
Neon-Line S - Swim	14 W/m	TBC	TBC	TBC	240	50	155	35

The above output values are specified at CRI 90 as standard.

If the data that you require is missing, please contact your Vexica representative.

Vexica run regular development cycles, continuously optimising and balancing product specifications to best suit our customers. All information therefore, is intended as a guide and specifications may change on occasion without notice or announcement. Technical data is measured under controlled conditions, expected performance is within +/- 10% of advertised figures. Luminaire output stated is actual value from the luminaire itself. Information provided above is intended as a description of the product and shall not be used in the form of any contract.

## ELECTRICAL INFORMATION

Power Options	14W/m
Input Voltage	24 VDC (23V Min, 25V Max) - All Options
Dimmable	Yes
Connection Type	300mm Flying Lead (Input/Output or Input Only)
Cable Entry/Exit	End Feed Entry/Exit
	Side Feed Entry/Exit
LED Binning	3 SDCM
Maximum Chain Length	5m

## PHYSICAL & ENVIRONMENTAL INFORMATION

Housing Colour



White

Finish	Flexible White Silicone
Ambient Operating Temperature	-20°C to +45°C (+55°C at 9W)
Ambient Storage Temperature	-20°C to +60°C
IP Rating	IP68
IK Rating	IK08
Weight	0.366 kg/m

LED CCT/COLOUR OPTIONS

STATIC WHITE

2700K, 3000K, 3500K, 4000K, 5000K, 6000K



TUNABLE WHITE

2500K to 4500K



TUNABLE COLOUR

RGB



LENGTH (L) OPTIONS

LED Colour	Minimum Length (mm)	Maximum Length (mm)	Length Increments (mm)	Length Options (mm)
Static White Tunable White RGB	54	5004	50	54, 104, 154, 204, 254, 304, 354, 404, 454, 504, 554, 604, 654, 704, 754, 804, 854, 904, 954, 1004, 1054, 1104, 1154, 1204, 1254, 1304, 1354, 1404, 1454, 1504, 1554, 1604, 1654, 1704, 1754, 1804, 1854, 1904, 1954, 2004, 2054, 2104, 2154, 2204, 2254, 2304, 2354, 2404, 2454, 2504, 2554, 2604, 2654, 2704, 2754, 2804, 2854, 2904, 2954, 3004, 3054, 3104, 3154, 3204, 3254, 3304, 3354, 3404, 3454, 3504, 3554, 3604, 3654, 3704, 3754, 3804, 3854, 3904, 3954, 4004, 4054, 4104, 4154, 4204, 4254, 4304, 4354, 4404, 4454, 4504, 4554, 4604, 4654, 4704, 4754, 4804, 4854, 4904, 4954, 5004

MOUNTING ACCESSORIES

SURFACE MOUNT CLIP

Stainless Steel



ORDER CODE: 025132

RIGID CHANNEL

Clear Plastic



ORDER CODE: 025133

FLEXIBLE CHANNEL

Stainless Steel



ORDER CODE: 025134

VEXICA

VEXICA.COM | SALES@VEXICA.COM | +44 (0)113 243 4813

Page 4 of 7

PRODUCT DIMENSIONS

L	= Total Length	L1	= Length Increment
La	= LED Strip Length	N	= Integer Number
Lb	= Luminous Surface Length		

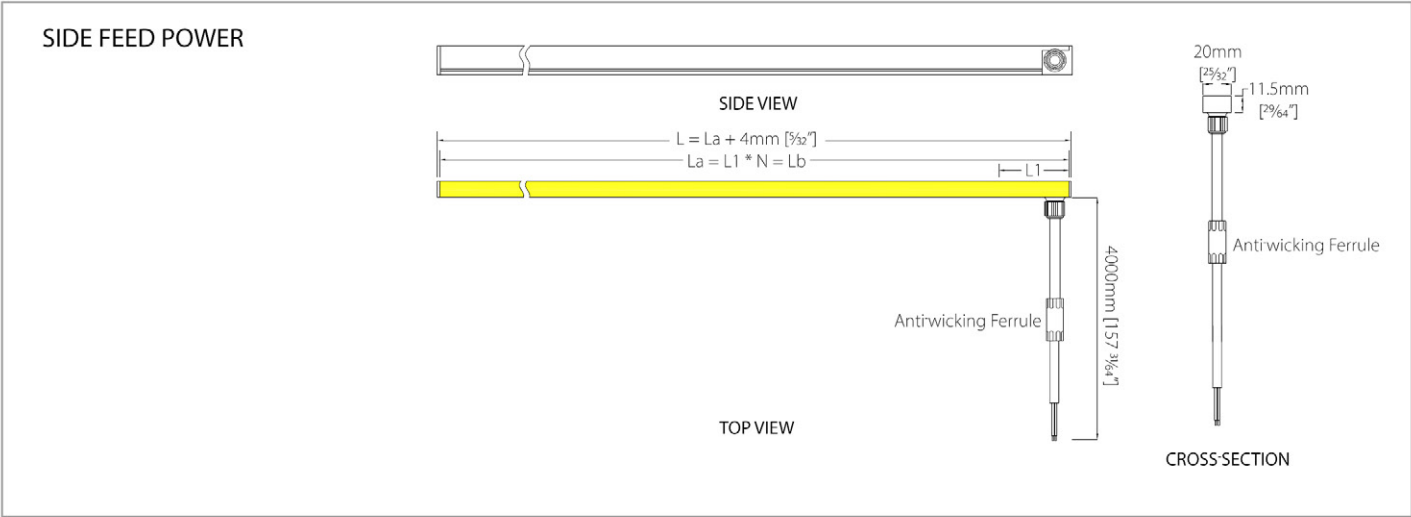
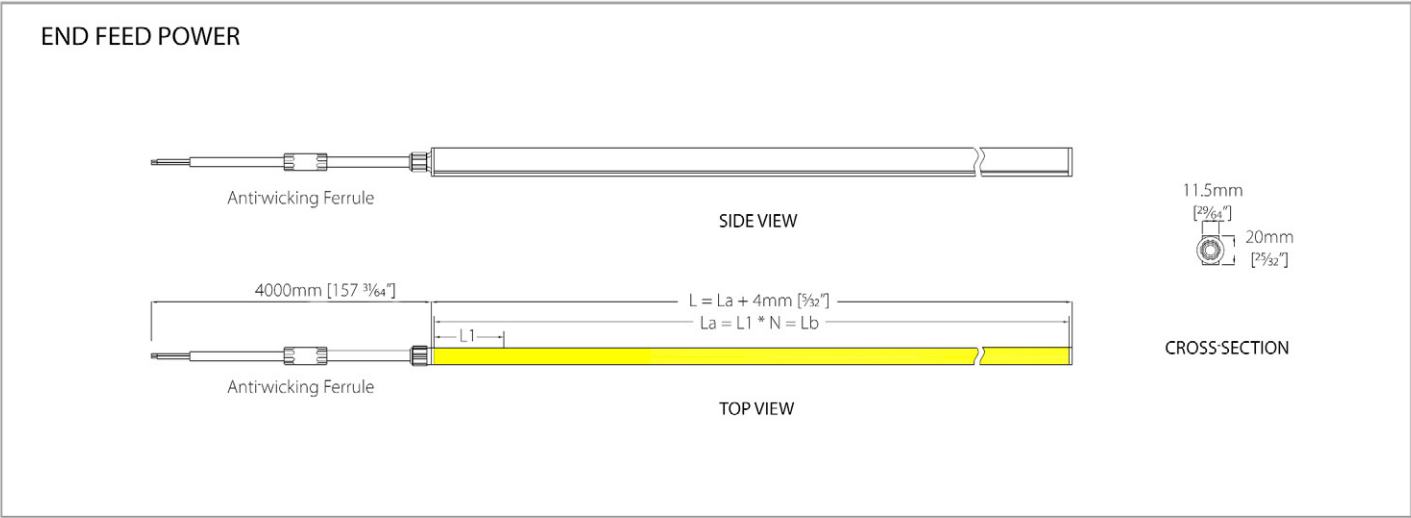

**NOTE**

The anti-wicking ferrule is not a substitute for proper waterproofing of installation on-site.

Removal of anti-wicking ferrule will void the luminaire warranty.

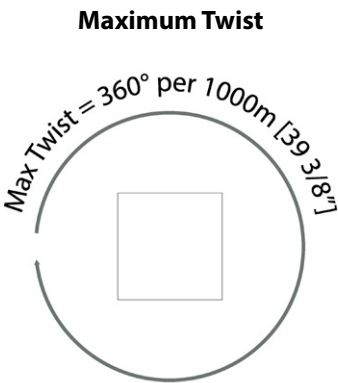
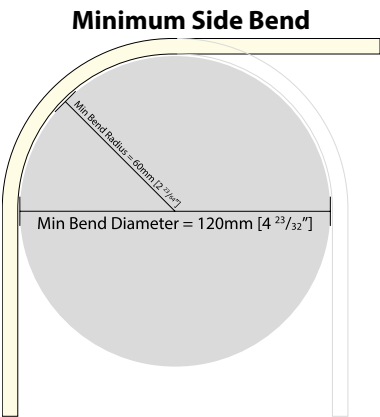

FIXTURE ORDERING

Project Name

1) FIXTURE & OUTPUT TYPE

PRODUCT	CCT/LED COLOUR	
VEX-NEON-LINE-S		
Neon-Line S is a Side Bending, Exterior-Grade Flexible Silicone LED Luminaire. (11.5mm x 20mm)	2700K 3000K 3500K 4000K 5000K 6000K TW-2500K-4500K RGB	Static White (2700K) Static White (3000K) Static White (3500K) Static White (4000K) Static White (5000K) Static White (6000K) Tunable White (2500K to 4500K) Tunable Colour (RGB)

2) LUMINAIRE LENGTH, POWER & MODEL

LENGTH	POWER OPTION	MODEL IDENTIFIER
	14W	SP
Xmm  Minimum = 54mm Maximum = 5004mm Increments = 50mm	14W  14W/m	SP  Neon-Line Swim (Designed for Swimming Pool Use)

3) IP RATING, BEAM PATTERN & END TYPE

IP RATING	BEAM PATTERN	END TYPE
IP68	DIF	
IP68  Suitable for wet environments and submersion.	DIF  Diffuse Homogeneous	INPUT-ONLY-EF INPUT-ONLY-SF End Feed, Input Only Side Feed, Input Only

PRODUCT CODE:

EXAMPLE: VEX - NEON - LINE - S - 2700K - 5004mm - 14W - SP - IP68 - DIF - INPUT - ONLY - EF

MOUNTING ACCESSORIES

PART NO.	DESCRIPTION	PRODUCT CODE
025132	Metal surface fixing clip	VEX-NEON-LINE-S-SP-ACCESSORY-SURFACE-MOUNT-CLIP
025133	Rigid clear plastic channel (1m)	VEX-NEON-LINE-S-SP-ACCESSORY-RIGID-CHANNEL-1000mm
025134	Flexible stainless steel channel (1m)	VEX-NEON-LINE-S-SP-ACCESSORY-FLEXIBLE-CHANNEL-1000mm

## STANDARDS & CERTIFICATIONS

### Compliance

Standard Marks



### Environmental Suitability

Recyclable

Not Recyclable

### Reliability

Quality Assurance

All products are carefully selected and tested by Vexica so that you can be assured of their quality, function and reliability.

### Warranty & Terms

Terms & Conditions

Warranty Registration

For details on our warranty and business terms, please click or scan the QR Code.

### Notes

