

INSTALLATION GUIDE FOR **LUMAERA 19**

VEX-LUMAERA-19

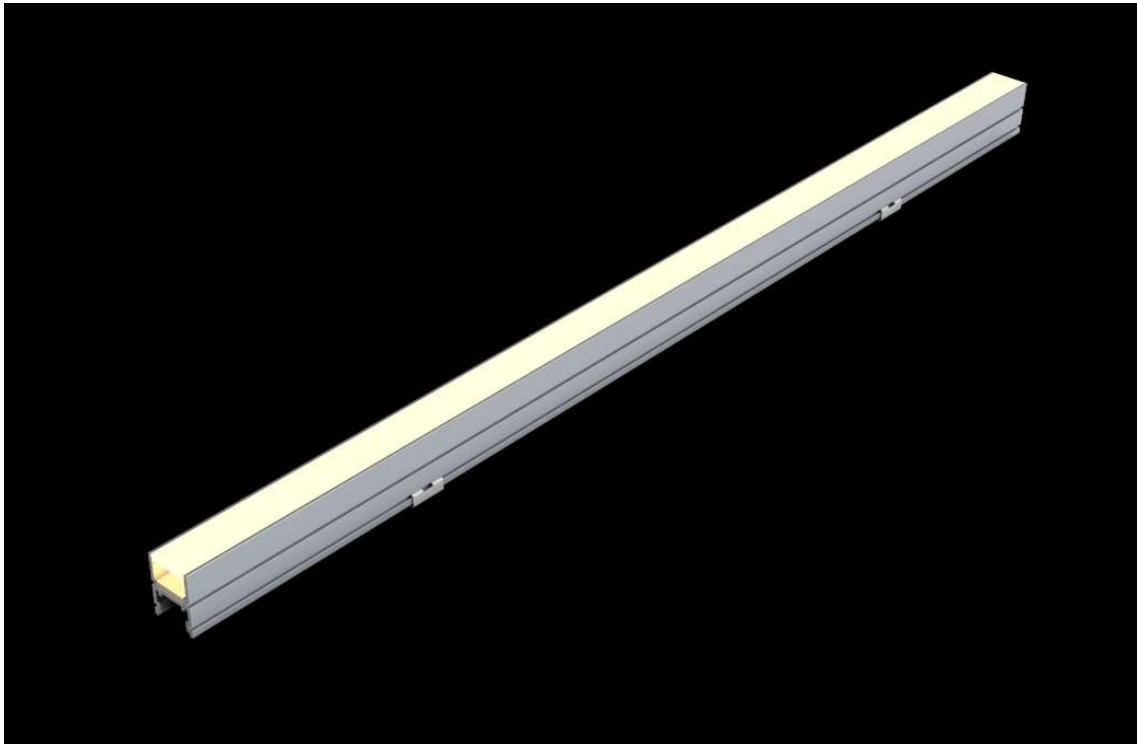

Please ensure you have read the following instructions thoroughly and can undertake the required actions before commencing installation.

If you have any queries, please consult our Technical Support Department before proceeding.

Contents

Scope.....	2
Revision History	2
Installation Instructions:	3
Spring Clips:.....	3
Adjustable Bracket:	4
Wiring.....	5
Single Colour	6
Tunable White	6
RGB	7
RGB Dynamic	7
RGBW	8
Extending Vexica Standard Input Cables	9
Cautions	10

Scope

This manual will detail the installation of VEX-LUMERA-19.

Revision History

Rev	Date	Comment	Author
A	10/06/2019	Document created	JP
B	09/10/19	Added twisting of data cables in RGB-DYN	JP
C	23/02/2021	Reword of wiring cautions	JP

Approved By

Person	Date	Name
Technical Manager	10/06/2019	Andy Slater

Installation Instructions:

Please read these instructions carefully before installation and make sure you fully understand them. Also, pay attention to how the luminaire is wired. If you require any further guidance, please contact Vexica.

Spring Clips:

Fix mounting clips to the required surface using appropriate screws (Vexica do not provide these as the type and size depends on the surface the luminaire is mounted to). Ensure the mounting brackets are installed in line with each other to enable the product to be clipped in easily. Press the luminaire into the brackets, use at least two Spring Clips with luminaires one meter and under and three brackets if the luminaire is over one meter.

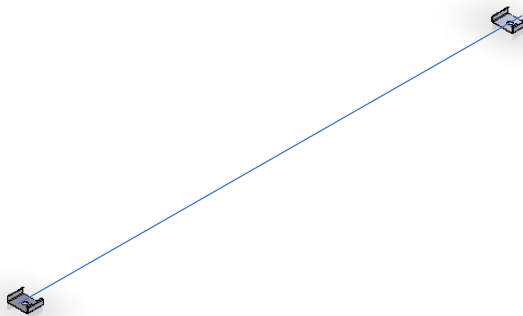

Press the Fitting into the Spring Clips.

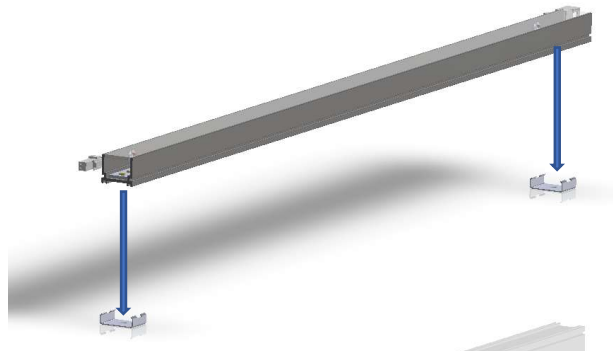

Connect fittings using the connectors ensure that the last Fitting in a 'String' is terminated to preserve the product's IP Rating. Connect a starter cable to the first Fitting (see Page Nine for more wiring information).

Adjustable Bracket:

Fix adjustable bracket to the required surface using appropriate screws (Vexica do not provide these as the type and size depends on the surface luminaire is mounted to). Ensure the mounting brackets are installed in line with each other to enable the product to be clipped in quickly. Use at least two Brackets with luminaires one meter and under and three brackets if the luminaire is over one meter.

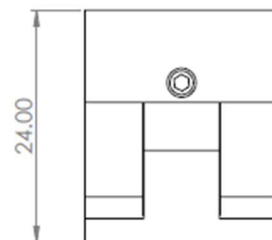
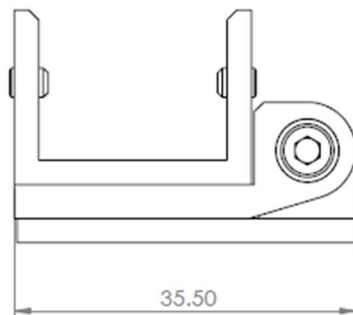
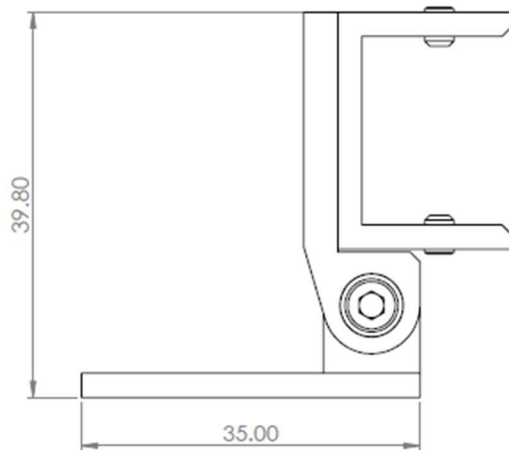

Loosen the Grub Screws with a 2mm Allen key and fit the Unit into the bracket. Tighten Grub Screws to secure the Fitting in place. Ensure that the Fitting is pressed firmly into the bracket to ensure that the Grub Screws engage fully.

Wiring

WARNING! Risk of electrical shock. Disconnect power before servicing or installation.

ONLY USE VEXICA APPROVED DRIVER

- Please take note of the luminaire and driver ingress protection rating when deciding the location.
- Make sure all connections made are tight, with no loose strands and with appropriate IP rated connectors and terminators if applicable.
- Do not reverse polarity.
- Always allow enough slack in the supply cable to remove the luminaire from its position for further maintenance.
- Make sure the supply cable is not in contact with any sharp objects.
- To prevent the ingress of moisture through the cable, do not allow rain/moisture to contact the exposed end of the cable or open connectors for any period.

<u>Power/m version</u>	<u>Max Chain Length</u>
6W	9.6m
10W	5m
15W	4.8m

Table 1

Securely mount PSU/LED driver and connect starter cable following the colour coding:

Single Colour

Wire Colour	Function
Red	+24 VDC
Black	GND

Table 2

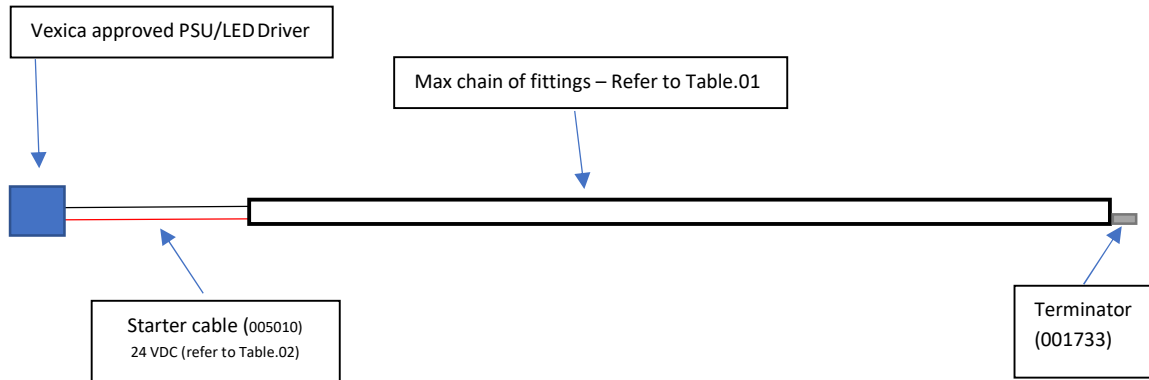

Tunable White

Wire Colour	Function
Red	+24 VDC
White	Channel 2
Black	Channel 1

Table 3

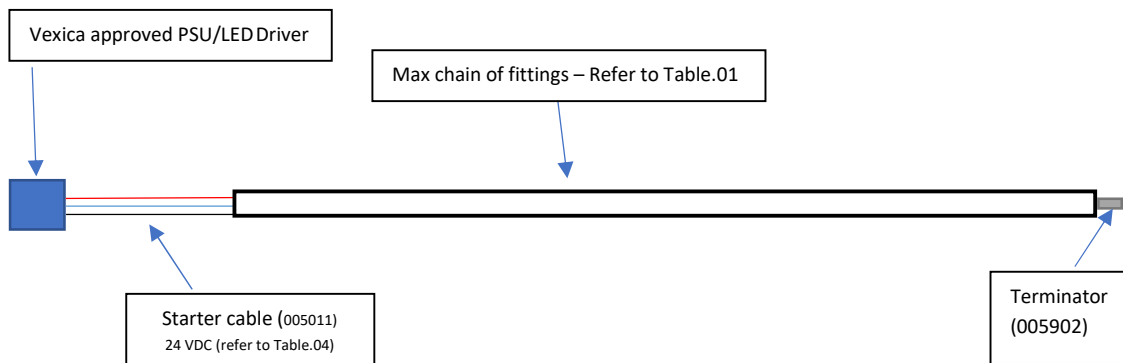

RGB

Wire Colour	Function
Red	RED GND
Green	GREEN GND
Blue	BLUE GND
Black	+24 VDC

Table 4

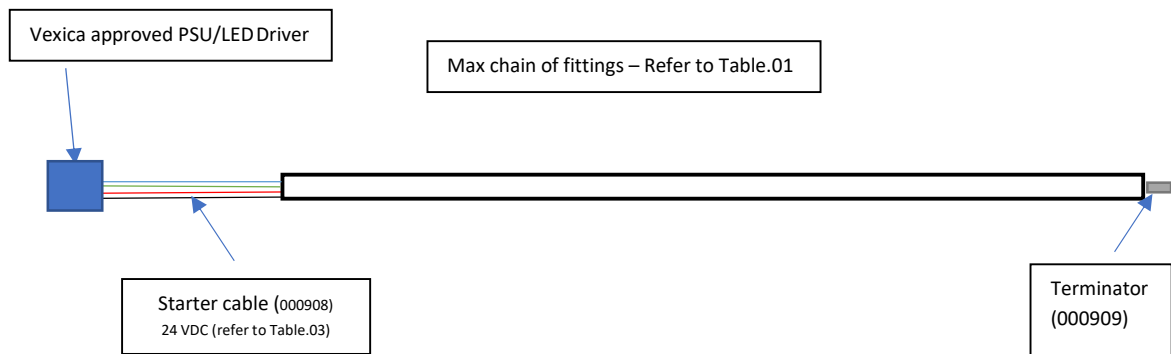

RGB Dynamic

Wire Colour	Function
Red	+24 VDC
White	Data
Black	GND

Table 5

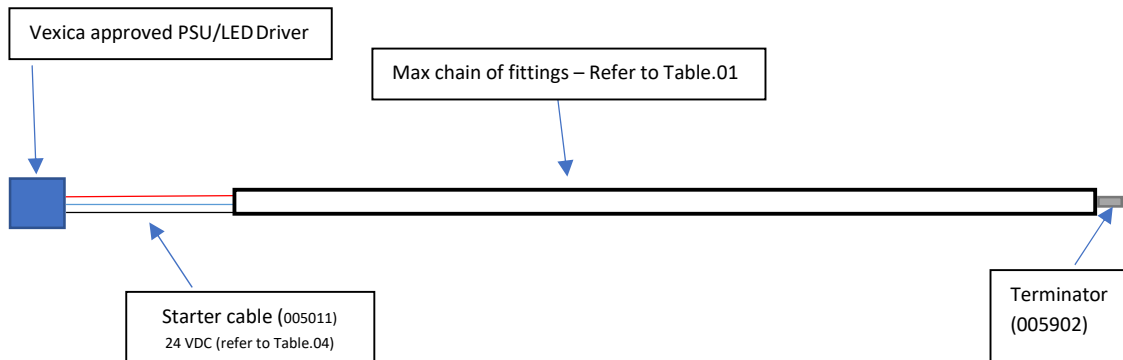

WITH ALL RGB/RGBW-DYNAMIC FITTINGS, THE STARTER CABLE MUST NOT EXCEED ONE METER, THE DATA (WHITE) AND GND (BLACK) CABLES MUST BE TWISTED TOGETHER.

RGBW

Wire Colour	Function
Red	RED GND
Green	GREEN GND
Blue	BLUE GND
White	WHITE GND
Yellow	Not Used
Black	+24 VDC

Table 6

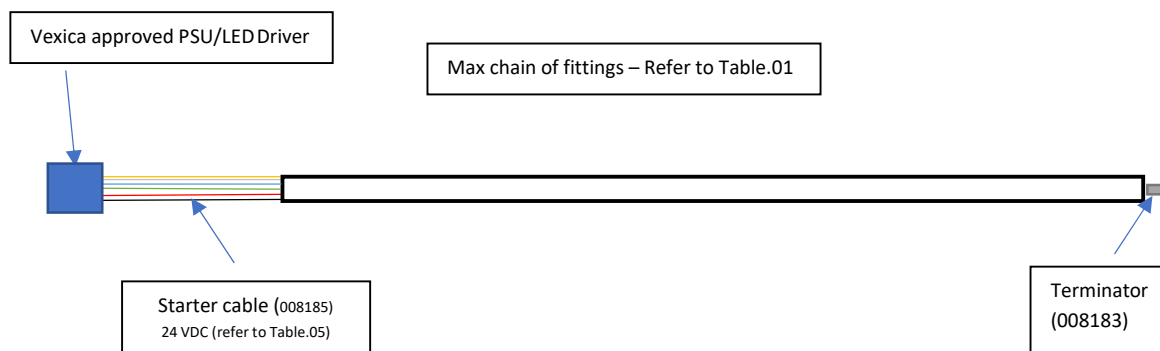

ALWAYS TERMINATE THE END OF A CHAIN TO RETAIN IP RATING

2 WAY TERMINATOR – VEXICA PART NUMBER: 001733

3 WAY TERMINATOR – VEXICA PART NUMBER: 005902

4 WAY TERMINATOR – VEXICA PART NUMBER: 000909

6 WAY TERMINATOR – VEXICA PART NUMBER: 008183

DO NOT REVERSE POLARITY

Extending Vexica Standard Input Cables

When extending cables or making any connections on-site, always ensure the connection has an appropriate IP rating.

Vexica recommends that the starter cables are linked to extensions cables with gel boxes. When extending sheathed cables, ensure that the outer sheath is encased in the gel box to retain the IP rating.

Do Not extend Dynamic starter cables without using a Vexica approved Transmitter/Receiver module to ensure smooth playback of data.

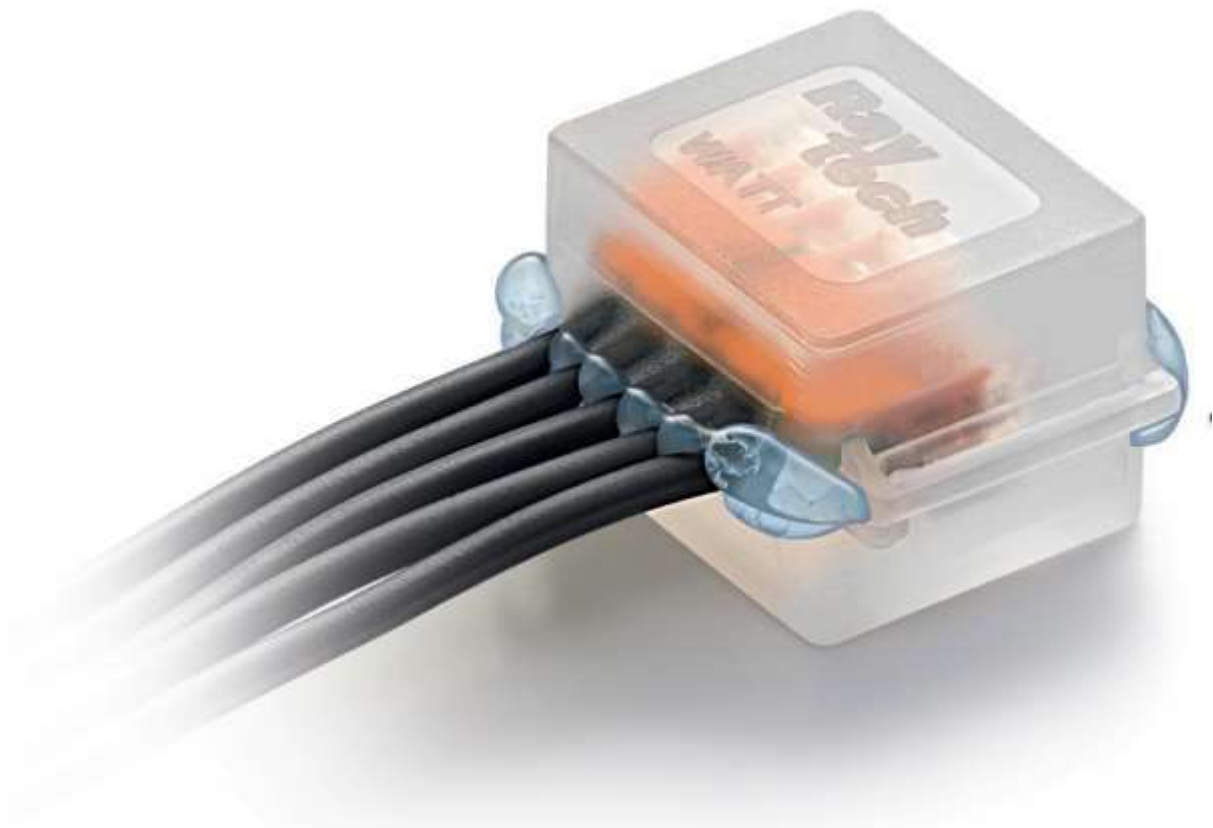

For more details, visit: <http://www.raytech.it/catalogo/en/gel-box-line.pdf>

Cautions

PLEASE TAKE NOTE OF LUMINAIRE AND DRIVER INGRESS PROTECTION RATING WHEN DECIDING LOCATION

MAKE SURE ALL CONNECTIONS MADE ARE TIGHT WITH NO LOOSE STRANDS AND WITH AN APPROPRIATE IP RATING.

DO NOT HOT-PLUG OR REVERSE POLARITY.

ALWAYS ALLOW SUFFICIENT SLACK ON THE SUPPLY CABLE TO REMOVE THE LUMINAIRE FROM ITS POSITION FOR ANY FURTHER MAINTENANCE

MAKE SURE THE SUPPLY CABLE IS NOT IN CONTACT WITH ANY SHARP OBJECTS; DO NOT LEAVE CABLE OR ANY CONNECTOR EXPOSED TO RAIN/MOISTURE FOR ANY PERIOD

CAUTION!

- *All images are representative and may not be of the product supplied, depending on options specified when ordering.*
- *Avoid staring directly into the light beam.*
- *The product should be installed by a certified electrician and follow local regulations.*
- *Take extreme care when working with mains voltages.*
- *There are no user-serviceable parts inside this Unit. Do not attempt any repairs yourself. Doing so will void your manufactures warranty.*
- *During operation, the housing may become hot. Avoid touching the Unit with bare hands while in use.*
- *Do not allow the product to operate in ambient temperatures above the maximum ambient stated on the datasheet; doing so will void any warranty.*
- *Do not use aggressive cleaning agents! Any warranty will not cover any chemical damage to the seals.*
- **DO NOT "HOTPLUG" THE LED FITTINGS OR DRIVERS, AS THIS WILL INVALIDATE THE WARRANTY!**