

Hybrid Drive 6 - ‘All-in-One’ LED Driver & Contoller

[005965] VEX-HYBRID-DRIVE-6

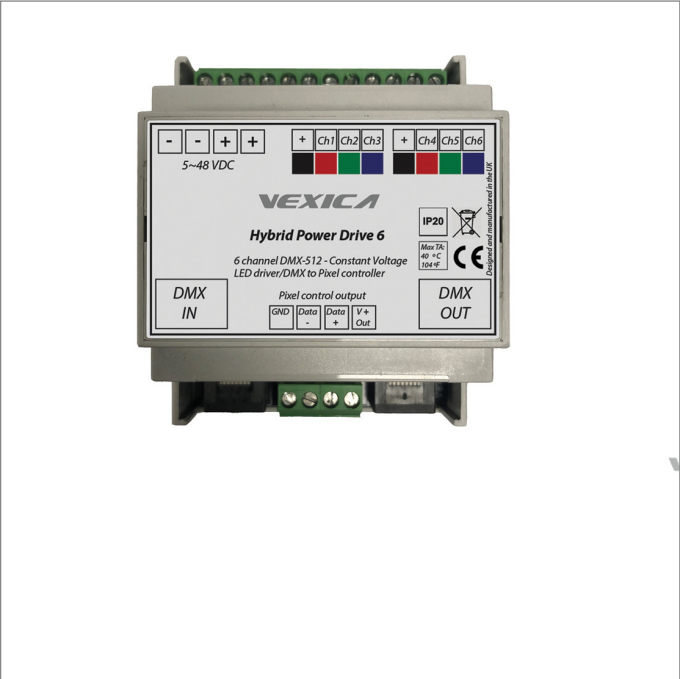

Hybrid Drive 6 is a versatile ‘all-in-one’ constant voltage LED driver that provides 6 channels of PWM output, from a supplied voltage range of 12-48VDC, or a DMX to SPI data conversion output to control dynamic pixel technology.

Features:

- 6 channels of PWM output
- Individually addressable DMX channels
- Control up to 170 RGB pixels
- Dimming range 0-100%
- Optimised thermal management
- RDM compatible configuration



CONTROL INFORMATION

Control Type (Input)	DMX-512 via RJ45
Ouput 1: x6 PWM	PWM on 6 channels
Output 2: SPI Out	Max 170 pixels via DMX
Setup	RDM

ELECTRICAL INFORMATION

Input Voltage	12-48 VDC
Data Connection	RJ45
Maximum Rated Power (W)	12V = 144      24V=288      48V=576
Control Input Type	DMX-512 RDM
Output	6 Channels PWM or 1 DMX Universe of Pixels

Max Loading per Channel (A)	CH1	CH2	CH3	CH4	CH5	CH6	TOTAL
	4	-	-	-	-	-	4
	4	4	-	-	-	-	8
	4	4	4	-	-	-	12
	3	3	3	3	-	-	12
	2	2	2	2	2	2	12

IMPORTANT:  
DO NOT exceed the maximum per channel current loadings set out in this table.

PHYSICAL & ENVIRONMENTAL INFORMATION

Finish	ABS DIN Case		
Mounting Method	DIN Rail 35mm		
Screw Terminal Pitch	5mm		
Ambient Operating Temperature (°C)	Constant Voltage Mode	-10 to +50	
	Data Only Mode	-10 to +50	
Ambient Storage Temperature (°C)	-30 to +85 (non-condensing)		
IP Rating	IP20 (Indoor ONLY)		
IK Rating	n/a		
Connection Type	Screw Terminal (0.5Nm Torque)		
Connector Information	Solid Cable	0.2 - 0.4mm	(30-12 AWG)
	Stranded Cable	0.2 - 2.5mm	(30-12 AWG)

PRODUCT DIMENSIONS

Max Height (mm)	90.0
Max Width (mm)	71.2
Max Depth (mm)	58.0
Weight (kg)	0.2
Dimension Diagram	

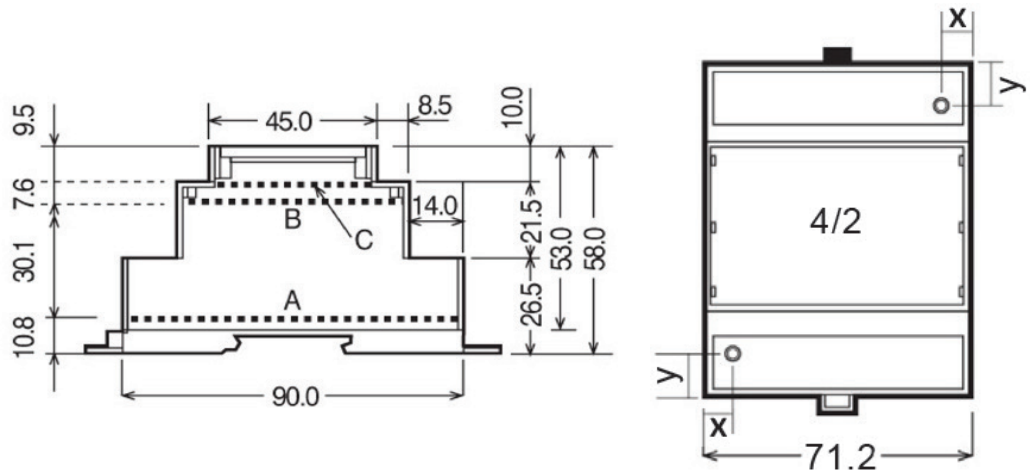

For further technical information, please see 'Hybrid Drive 6 Installation Instructions' or consult your Vexica representative.



VEXICA.COM | SALES@VEXICA.COM | +44 (0)113 243 4813

VEXICA TECHNOLOGY | Typhoon House, Moxon Way, Leeds, West Yorkshire, LS25 6FB, United Kingdom